

178

Smådycke från
Vadköping Museum.

Rask. Rødt linné. Foder 6
Triekstidningae phlokt. 5,
+ smør til blå Næstun ka
mad blott brød.

Skov

Timber: gum pine

blagum

Tram

hand

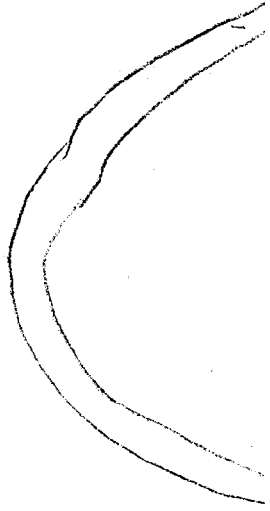

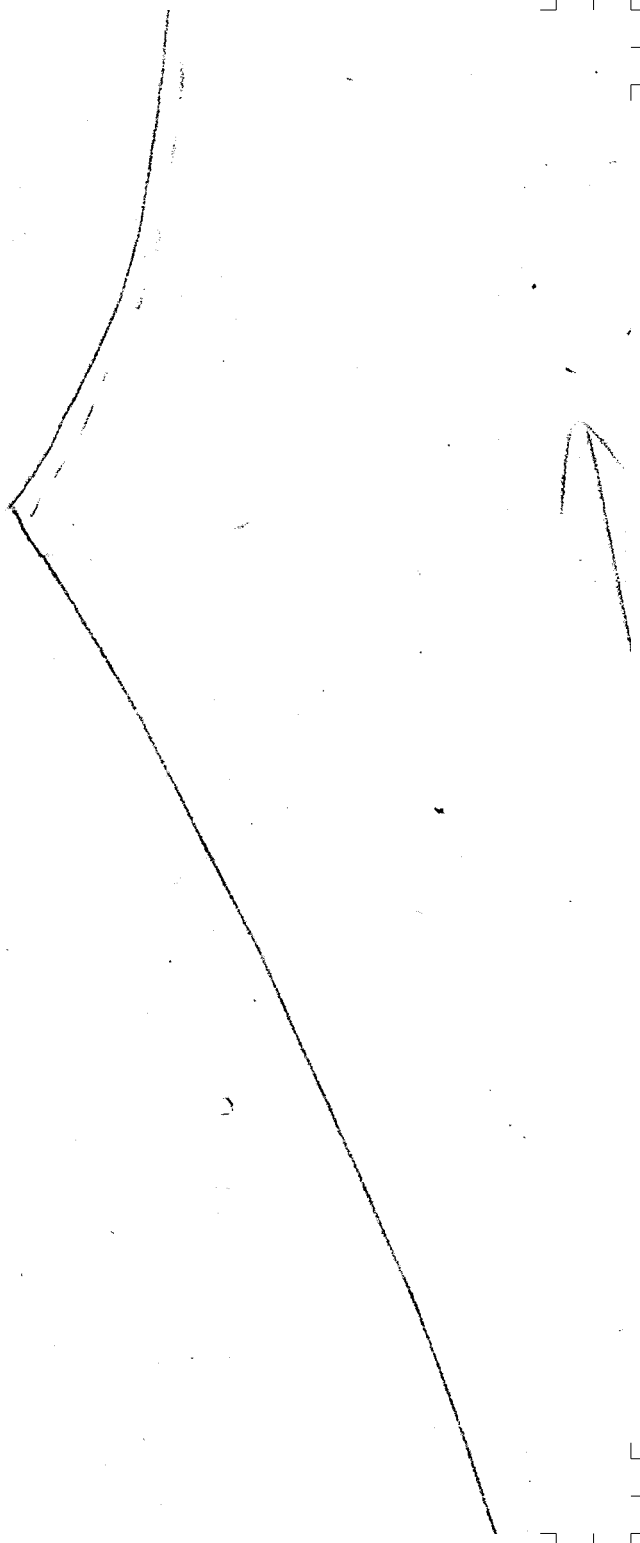

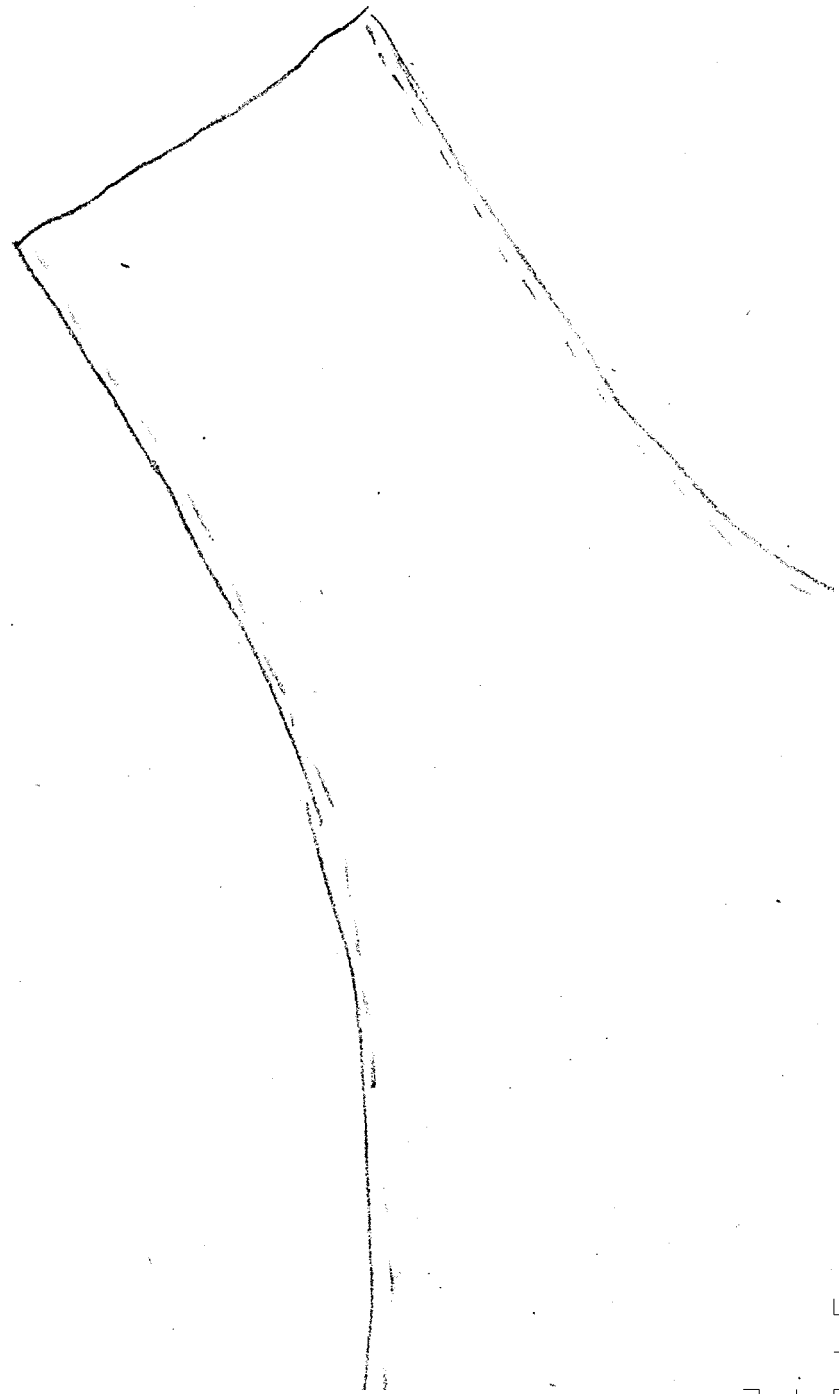

1-10/2

E

1-10/2

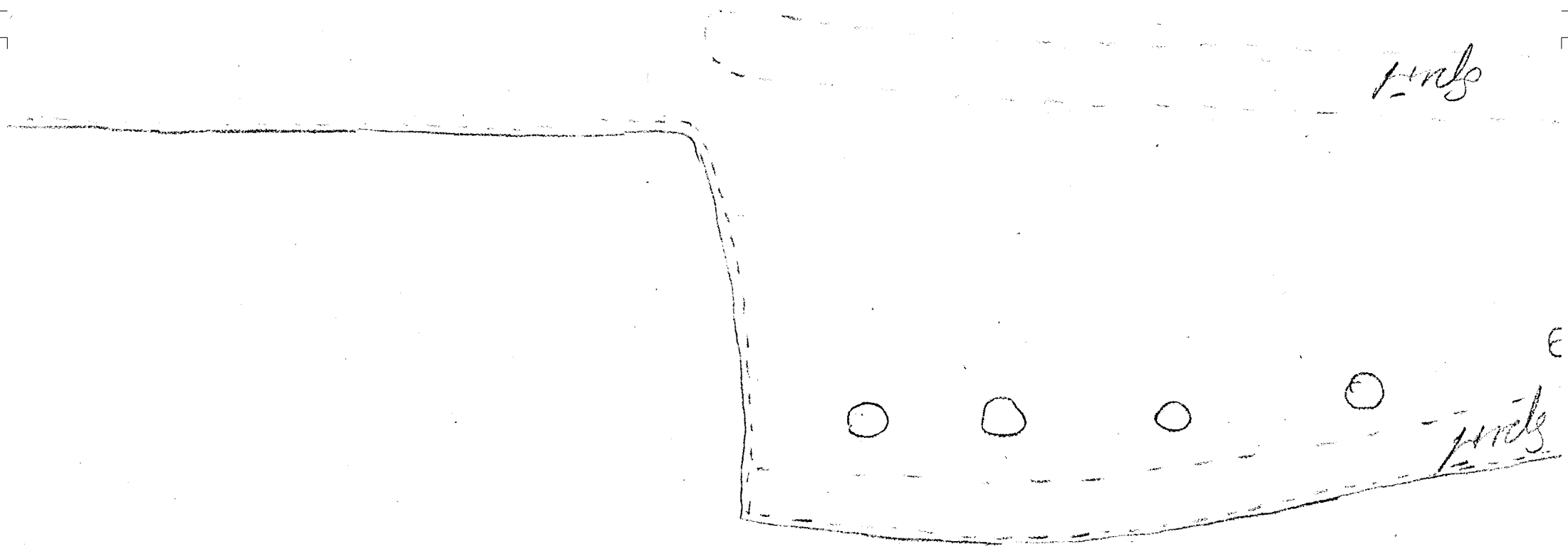

11/11/11

11/11/11

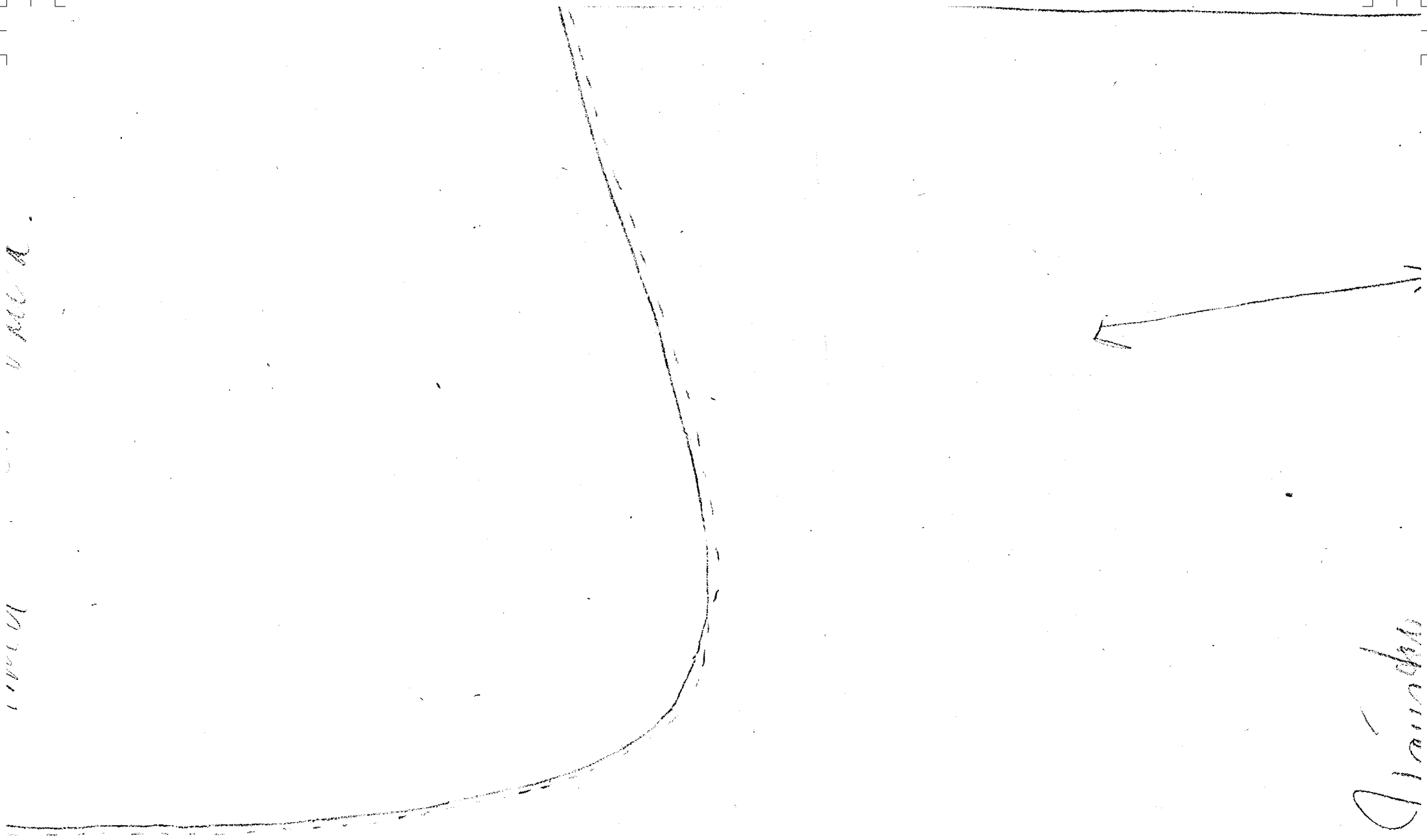

11/11/11

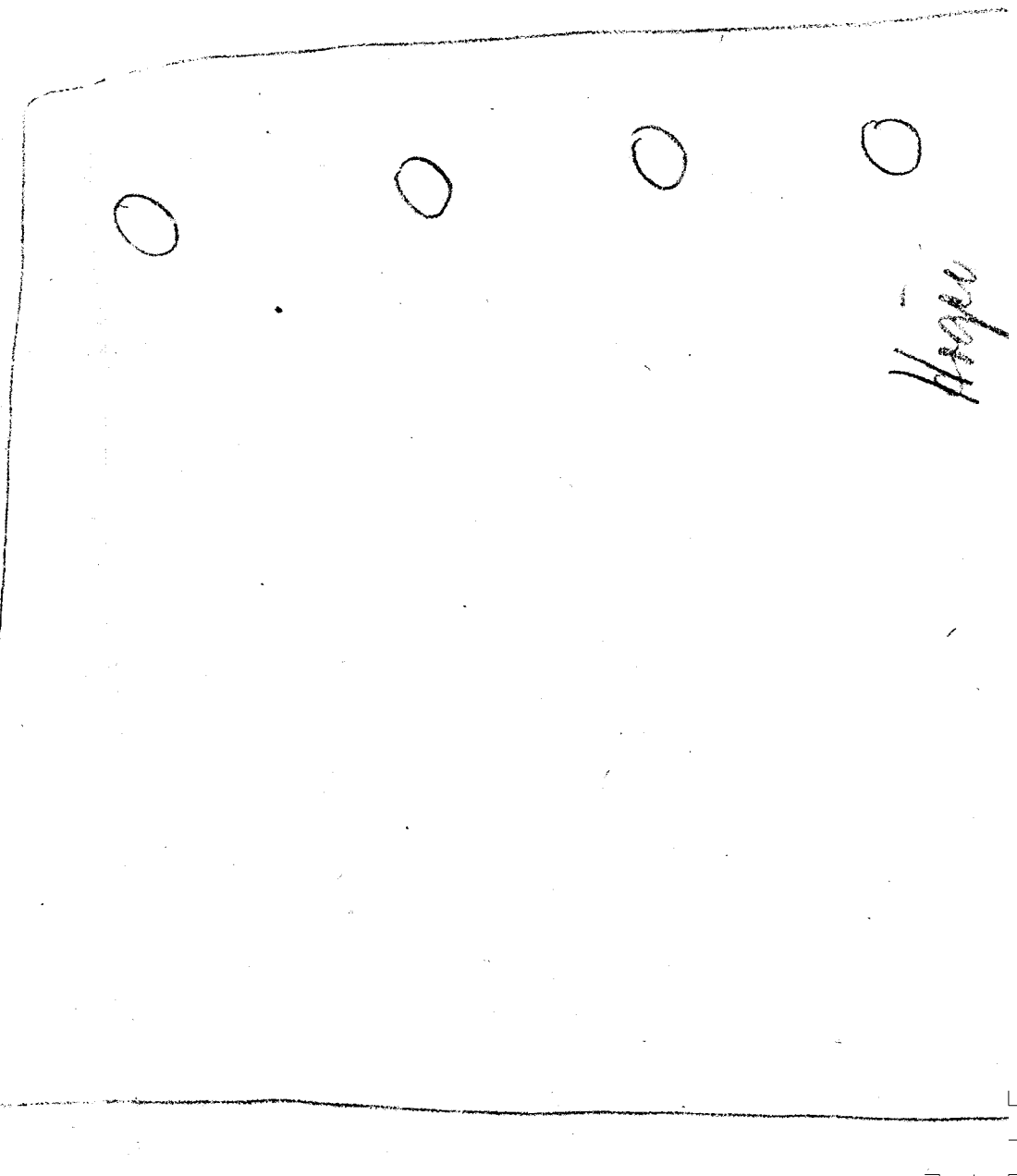
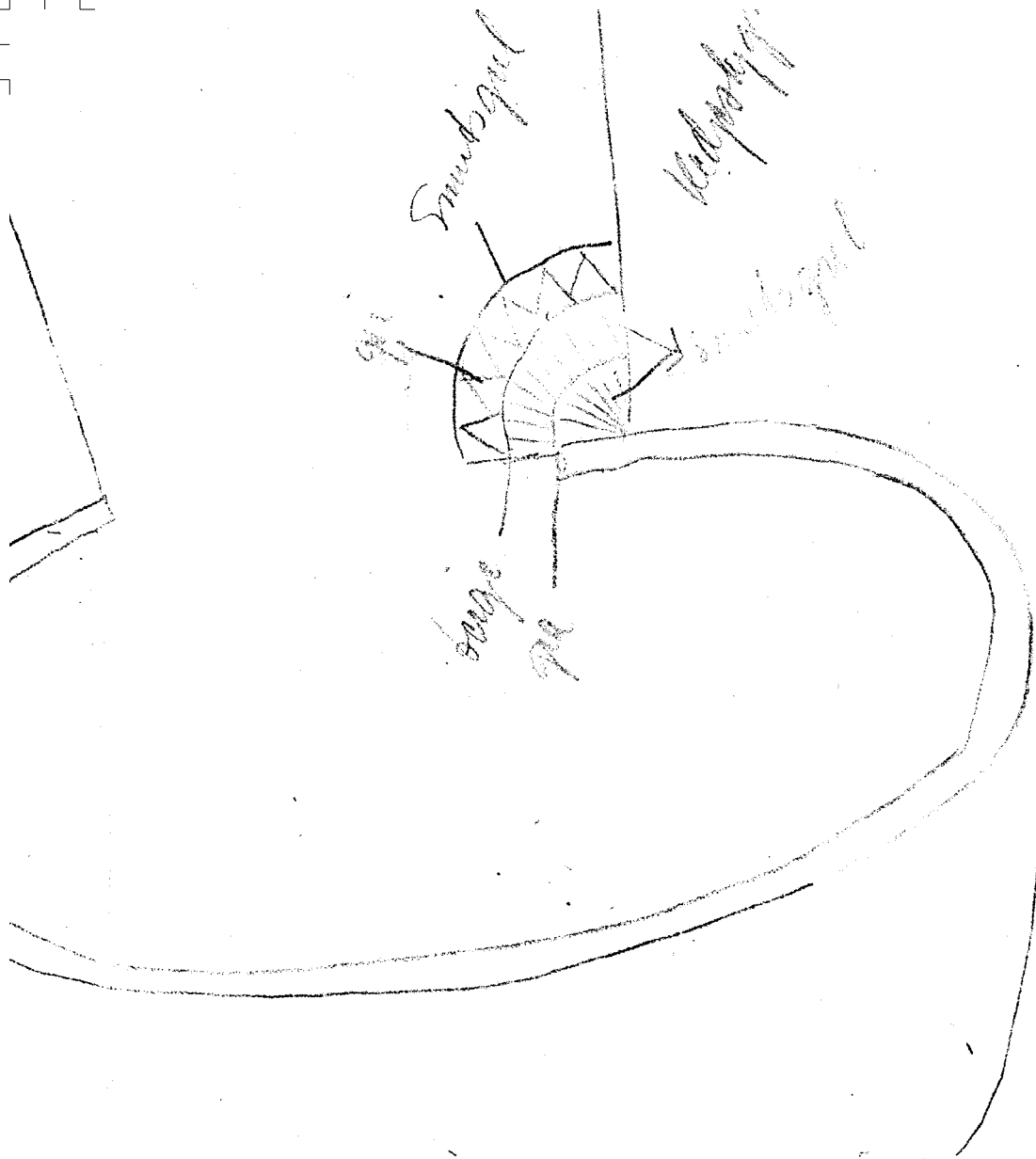



at

Egg for hatching

Jackon mill

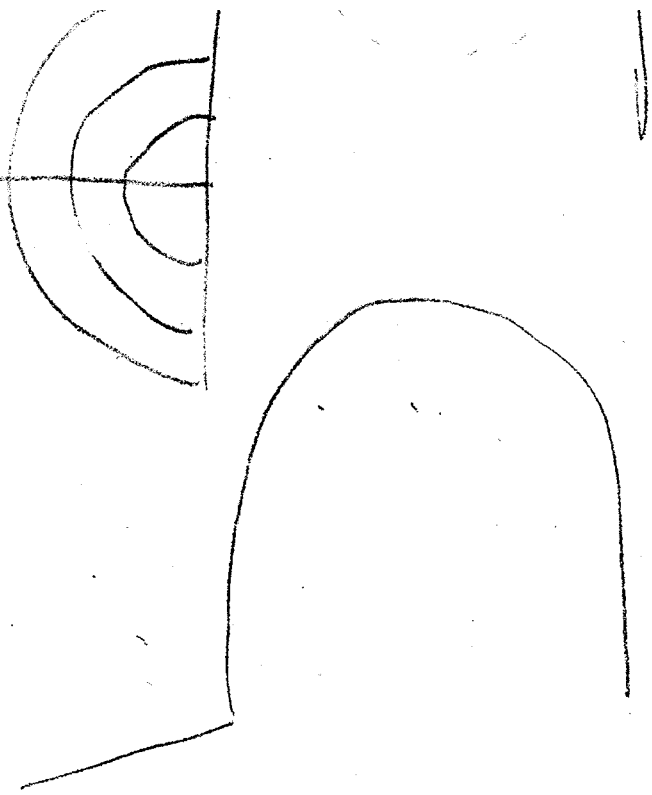

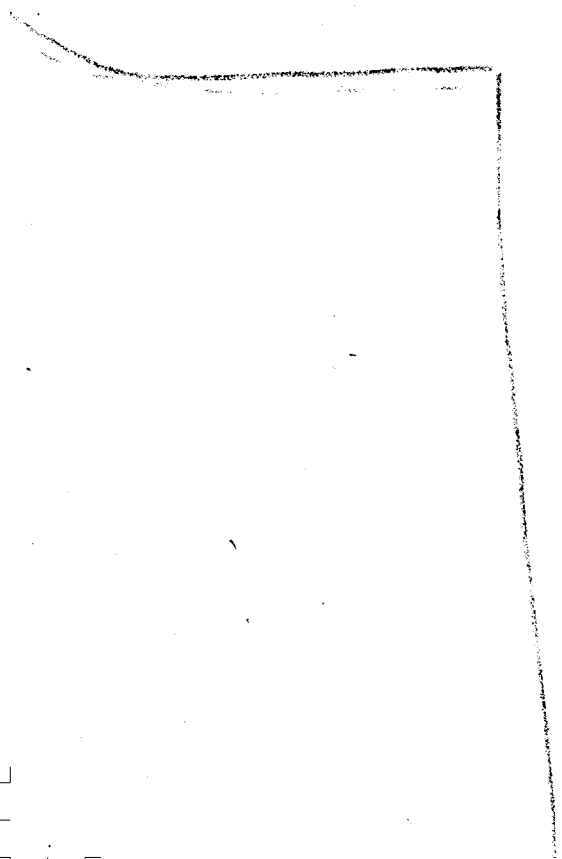

18 beds

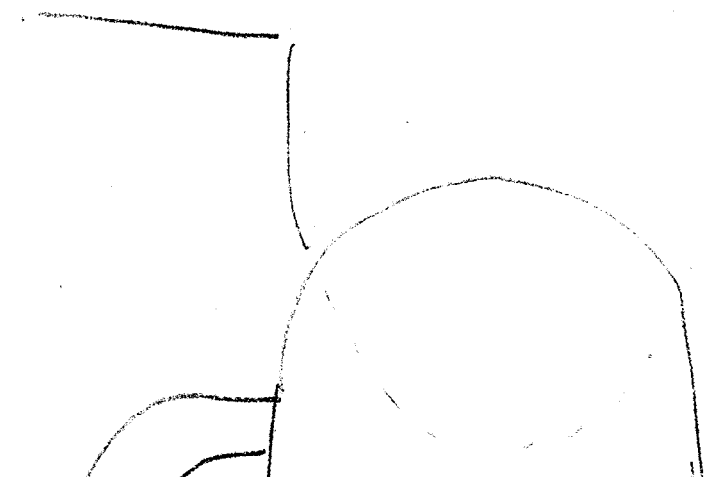

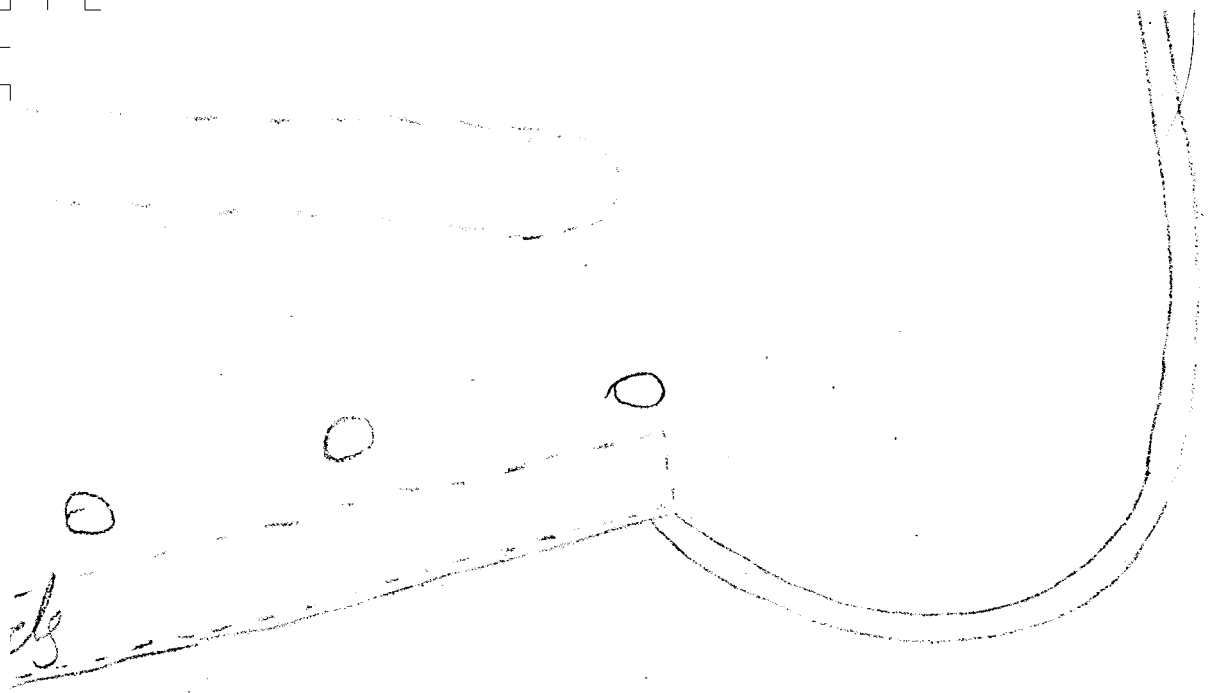

Fig

Yausoko

fram



Black ba

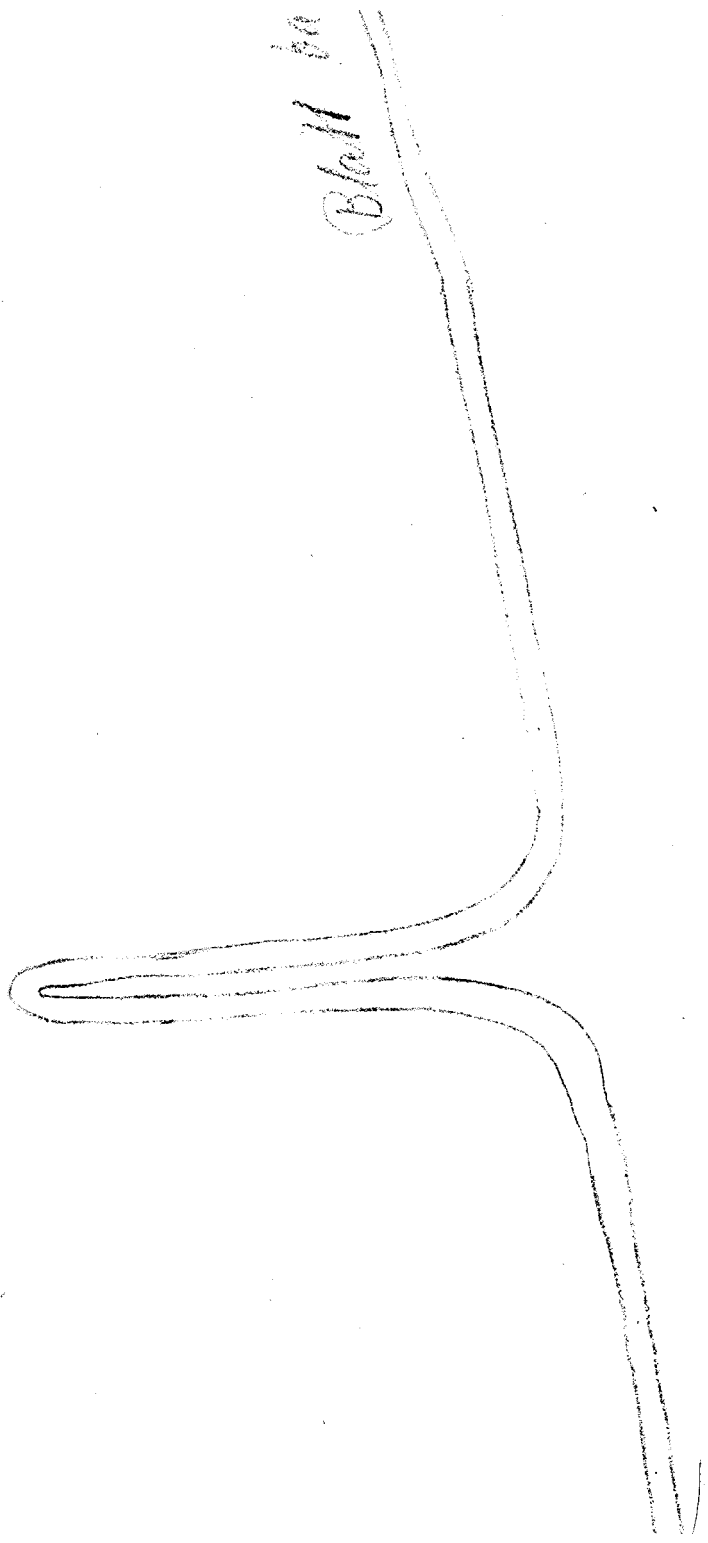



mapa
plan

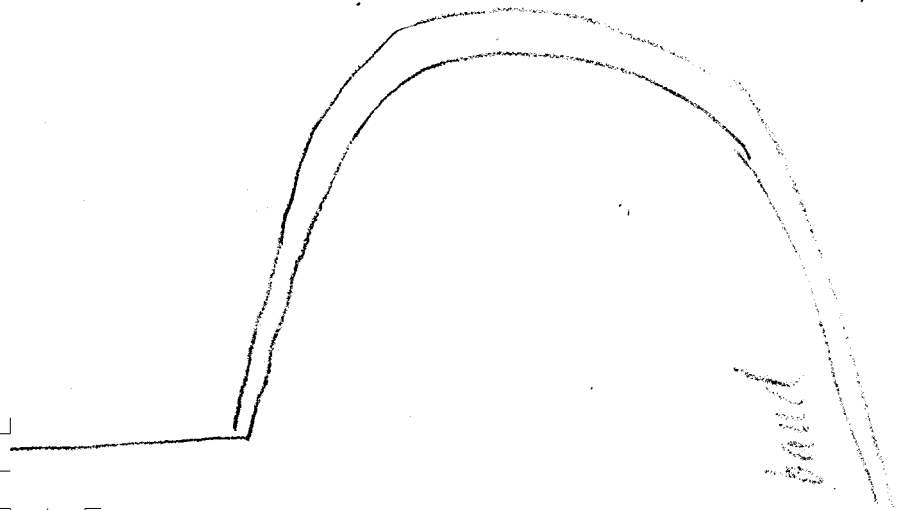

band



